

美制 JIC 外螺纹 74° 外锥面

SAE O-RING MALE

IOS 11962-SAE J1926

16711L

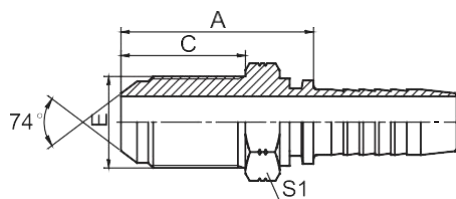

代号尺寸:

代号 PART NO.		螺纹 E THREAD E	软管 HOSE SIZE		尺寸 DIMENSIONS		
编织 BRAIDED	缠绕 SPIRAL		公称内径 DN	标号 DASH	A	C	S1
16711L-04-04Z	-	7/16"X20	6	4	45	32.5	17
16711L-05-04Z	-	1/2"X20	6	4	43	30.5	19
16711L-05-05Z	-	1/2"X20	8	5	43	30.5	19
16711L-06-04Z	-	9/16"X18	6	4	47	32.5	22
16711L-06-05Z	-	9/16"X18	8	5	47	32.5	22
16711L-06-06Z	16712L-06-06Z	9/16"X18	10	6	47	32.5	22
16711L-08-06Z	16712L-08-06Z	3/4"X16	10	6	51	36.5	22
16711L-08-08Z	16712L-08-08Z	3/4"X16	12	8	51.5	36.5	24
16711L-10-06Z	16712L-10-06Z	7/8"X14	10	6	56.5	40	30
16711L-10-08Z	16712L-10-08Z	7/8"X14	12	8	57	40	30
16711L-10-10Z	16712L-10-10Z	7/8"X14	16	10	58	40	30
16711L-12-08Z	16712L-12-08Z	1.1/16"X12	12	8	63.5	44.5	36
16711L-12-10Z	16712L-12-10Z	1.1/16"X12	16	10	64	44.5	36
16711L-12-12Z	16712L-12-12Z	1.1/16"X12	20	12	64.5	44.5	36
16711L-16-12Z	16712L-16-12Z	1.5/16"X12	20	12	66	44.5	41
16711L-16-16Z	16712L-16-16Z	1.5/16"X12	25	16	67	44.5	41
16711L-20-16Z	16712L-20-16Z	1.5/8"X12	25	16	70.5	45.7	50
16711L-20-20Z	16712LN-20-20Z	1.5/8"X12	32	20	71.2/73.8	45.7	50

16711L-24-20Z	16712LN-24-20Z	1.7/8"X12	32	20	71.5/74.1	46	55
16711L-24-24Z	16712LN-24-24Z	1.7/8"X12	40	24	71.5/74.5	46	55
<p>注：1.尺寸 A 中"/"前尺寸适用于编织管接头,"/"后尺寸适用于缠绕管接头。</p> <p>Notes: 1.The dimension A before"/" is for braided hose fitting and after "/" is for spiral hose fitting.</p>							