

公制铰接体

METRIC BANJO REF. DIN 7642

70011

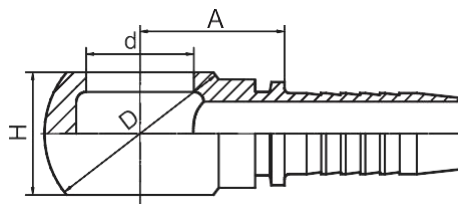

代号尺寸:

代号 PART NO.		螺栓 BOLT	软管 HOSE SIZE		尺寸 DIMENSIONS			
编织 BRAIDED	缠绕 SPIRAL		公称内径 DN	标号 DASH	A	d	D	H
70011-10-04Z	-	M10X1	6	4	17	10.1	17	10
70011-12-04Z	-	M12X1.5	6	4	20.5	12.1	20	12
70011-12-05Z	-	M12X1.5	8	5	20.5	12.1	20	12
70011-12-06Z	70012-12-06Z	M12X1.5	10	6	20.5	12.1	20	12
70011-14-04Z	-	M14X1.5	6	4	19	14.1	24	14
70011-14-05Z	-	M14X1.5	8	5	19	14.1	24	14
70011-14-06Z	70012-14-06Z	M14X1.5	10	6	21	14.1	24	14
70011-16-04Z	-	M16X1.5	6	4	20.5	16.1	28	16
70011-16-05Z	-	M16X1.5	8	5	20.5	16.1	28	16
70011-16-06Z	70012-16-06Z	M16X1.5	10	6	20.5	16.1	28	16
70011-18-04Z	-	M18X1.5	6	4	23	18.1	32	20
70011-18-05Z	-	M18X1.5	8	5	24	18.1	32	20
70011-18-06Z	70012-18-06Z	M18X1.5	10	6	24	18.1	32	20
70011-18-08Z	70012-18-08Z	M18X1.5	12	8	24.5	18.1	32	20
70011-22-06Z	70012-22-06Z	M22X1.5	10	6	28.1	22.1	39	25
70011-22-08Z	70012-22-08Z	M22X1.5	12	8	28.5	22.1	39	25
70011-22-10Z	70012-22-10Z	M22X1.5	16	10	27.5	22.1	39	25
70011-26-12Z	70012-26-12Z	M26X1.5	20	12	33.5	26.2	46	30
70011-30-16Z	70012-30-16Z	M30X1.5	25	16	37	30.2	54	36

70011-30-20Z	70012N-30-20Z	M30X1.5	32	20	41/43.1	30.1	54	36
<p>注： 1.尺寸 A 中"/"前尺寸适用于编织管接头,"/"后尺寸适用于缠绕管接头。</p> <p>Notes: 1.The dimension A before"/" is for braided hose fitting and after "/" is for spiral hose fitting.</p>								